

## PLASTERING & BLOCK ACCESSORIES

1. Angle / Corner Beads
2. Plaster Stop Beads
3. Control Joint Beads
4. Architrave Beads
5. Metal Lath (Coil / Sheets / Riblath)
6. Formwork - Hyrib
7. Steel Meshes (Fencing, Caging and Gratings)
8. Block Reinforcement Mesh (Coil Lath)
9. Ladder Type Reinforcement
10. Wall Ties & Anchors

**C.M.D.**

the **Construction Materials Division** of

A.A. Turki Corporation 

# EXPAMET BEADS®

## PLASTERING ACCESSORIES



### EXPAMET BEADS

Expamet are one of the world's largest producers of expanded metal products. Bead manufacture began over 40 years ago and today, if our total Bead production were laid end to end, it would stretch to the moon and back with miles to spare. As the established market leader in the UK, the Expamet Bead range is comprehensive, from high performance products through to easy-to-use economy beads. It's a choice backed by quality that today's tradesmen trust to deliver lasting, value for money performance.



### SPECIFICATIONS

- All Plaster Beads, channel and bead accessories and wire meet specifications ASTM C1063 for exterior applications and ASTM C 841 for interior applications.
- All Metal Lath meets American Society for Testing and Materials - ASTM A 653, and C 847.
- Galvanised Steel Beads meets BS EN 10142: 1991. DX51D + Z275 & DX51D + Z450.

### PLASTER BEADS

#### Angle Beads

Provides a true, straight corner which protects and reinforces plaster where it is most vulnerable. One size adjusts for thickness.

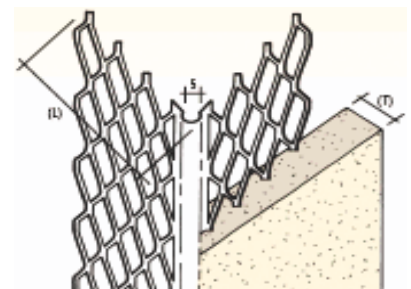

Ref. No.	Description
XPA-558	Galvanised Angle bead 50x50 mm
XPA-592	Galvanised Angle bead 64x64 mm
XPA-506	Stainless steel angle bead 53x53mm

## Thin Coat Angle Beads

Specially produced for use with all types of thin-coat plaster work, to provide protection and reinforcement at vulnerable points. This special design beads make them suitable for use wherever 3mm or 6mm

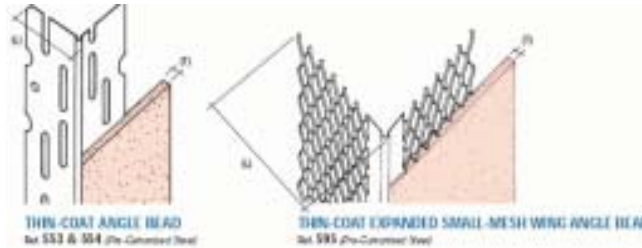

Ref. No.	Description
XPA-553	Galvanised Angle bead thin-coat 3 mm
XPA-595	Galvanised Angle bead thin-coat with wings

## Stop Beads

Stop Beads is an all-purpose square nose plaster stop (casing bead). It is used as a plaster stop for finishes and reinforces plaster edges, screed ground, and as exposed trim around doors and windows, as well a base screed.

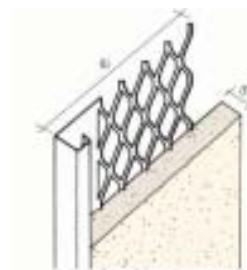

Ref. No.	Description (Plaster Depth-T)
XPA-562	10 mm
XPA-563	13 mm
XPA-565	16 mm
XPA-566	19 mm
XPA-570	External Render Stop

MANUFACTURED BY EXPAMET, U.K.

**EXCLUSIVE DISTRIBUTOR IN SAUDI ARABIA**  
**A.A. TURKI CORPORATION - Construction Material Division**

Khobar Sales Office : Tel. 882 7557 - Fax : 882 7095  
 Jeddah Sales Office : Tel. 691 2204 - Fax : 698 6553  
 Riyadh Sales Office : Tel. 476 2241 - Fax : 476 2485



## ARCHITRAVE & FEATURE BEAD

Designed to form a plaster stop and a shadow line recess around door frames and else where they provide a key for plaster and guide for ruling off.

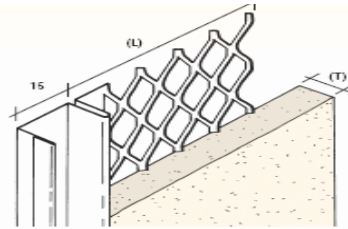

ARCHITRAVE BEAD (ENGAGING)

Creates feature at plaster edges, engaging with frame.

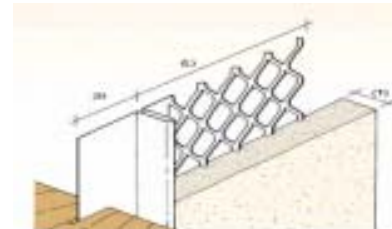

FEATURE BEAD (ABUTTING)

Creates feature at plaster edges, abutting with frame.



Ref. No.	Description
XPA-579	Architrave bead 13 mm

Ref. No.	Description
XPA-580	Architrave bead w/o return flag

## Control Joint Bead

Forms movement joints in plaster and render, assist in relieving stress in large plaster areas by reducing to a series of smaller segments.

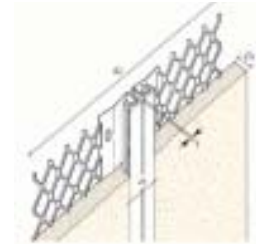

Ref. No.	Description
XPA-519	Control joint 13 mm
XPA-520	Control joint 19 mm
XPA-589	Movement bead 16mm with PVC extrusion

## RIB - LATH

Pre-galvanized carrier of render only to be used in sheltered/moderate exposure away from the coast. It is used in the construction of suspended ceiling and stud partition

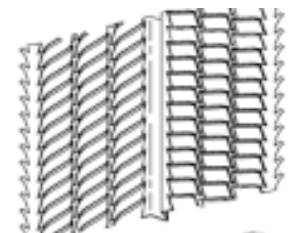

MANUFACTURED BY EXPAMET, U.K.

EXCLUSIVE DISTRIBUTOR IN SAUDI ARABIA

A.A. TURKI CORPORATION - Construction Material Division

Khobar Sales Office : Tel. 882 7557 - Fax : 882 7095

Jeddah Sales Office : Tel. 691 2204 - Fax : 698 6553

Riyadh Sales Office : Tel. 476 2241 - Fax : 476 2485



## RIB - LATH



Ref. No.	Description
XPA-269	Rib lath 10mm x 600mm x 2500mm

### Expanded Metal Lath

Used as a background for Plastering in partitions, suspended ceiling and fire protection to steel works, the diamond configuration of the mesh ensures an extremely reliable key with plaster materials also acts as an excellent reinforcement to the resulting structure suitable for use.



Ref. No.	Description (size) (density per m <sup>2</sup> )
Type 1	Metal Lath (0.6X2.5m) (0.61 kg/m <sup>2</sup> )
Type 2	Metal Lath (0.6X2.5m) (0.90 kg/m <sup>2</sup> )
Type 3	Metal Lath (0.6X2.5m) (1.11 kg/m <sup>2</sup> )
Type 4	Metal Lath (0.6X2.4m) (1.22 kg/m <sup>2</sup> )
Type 5	Metal Lath (0.6X2.5m) (1.40 kg/m <sup>2</sup> )
Type 6	Metal Lath (0.6X2.5m) (1.61 kg/m <sup>2</sup> )
Type 7	Metal Lath (0.6X2.5m) (1.84 kg/m <sup>2</sup> )

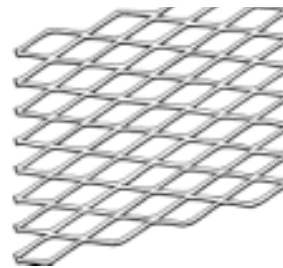

MANUFACTURED BY EXPAMET, U.K.

**EXCLUSIVE DISTRIBUTOR IN SAUDI ARABIA**  
**A.A. TURKI CORPORATION - Construction Material Division**

Khobar Sales Office : Tel. 882 7557 - Fax : 882 7095  
Jeddah Sales Office : Tel. 691 2204 - Fax : 698 6553  
Riyadh Sales Office : Tel. 476 2241 - Fax : 476 2485



# ATCO® LADDER MESH



ATCO® Ladder Mesh is manufactured with mason productivity and proper wall construction in mind. Cross rods are spaced so block cells are not obstructed, allowing easy placement of vertical rebars.

## ADVANTAGES

- ✓ Greatly reduces cracking that can arise from thermal stresses
- ✓ Enhances resistance to water penetration, as cracks are controlled
- ✓ Increases lateral flexural strength
- ✓ Increases elasticity
- ✓ Increases performance of masonry walls under various stresses.
- ✓ Fabricated in conformance with ASCE/ACI 530 building code requirements for masonry structures, and ASTM A 951 (standard specification for masonry joint reinforcement).



## MATERIAL CONFORMANCES - Block REINFORCEMENT ATCO®

**Joint reinforcement products “Ladder Mesh”** conform to Standard Specification ASTM A 951 & ACI / ASCE 530 (Building Code Requirements for Masonry Structures) **WIRE (Carbon Steel):** Cold-drawn steel wire conforming to ASTM A 82: Tensile strength - 80,000 p.s.i.

Yield Point - 70,000 p.s.i. minimum WIRE DIAMETER: 9 gauge (.148" or W1.7) 3/16" (.187" or W2.8) Side Rods and Cross Rods available in any combination of the above. Cross Rods welded 16" O.C.

**FINISHES:** Mill galvanized coating: ASTM A 641 (0.1 oz./ft.<sup>2</sup>) Also available on special order: ASTM A 641 Class 1 (0.4 oz./ft.<sup>2</sup>). ASTM A 641 Class 3 (0.8 oz./ft.<sup>2</sup>). Hot-dip galvanized after fabrication: ASTM A 153 (1.5 oz./ft.<sup>2</sup>). Stainless Steel: ASTM A 580, AISI Type 304 (Type 316 available on special order).

## SIZES

L	-	LENGTH	-	Standard 3 meter, or as requested
W	-	WIDTH	-	50 mm UP TO 310 mm
SL	-	SPACING OF L BARS	-	50, 100, 150, 200, 250, 300, 400 mm
SC	-	SPACING OF C BARS	-	430 mm



## SALES OFFICES IN SAUDI ARABIA

### A.A. TURKI CORPORATION - Construction Material Division

Khobar Sales Office : Tel. 882 7557 - Fax : 882 7095

Jeddah Sales Office : Tel. 691 2204 - Fax : 698 6553

Riyadh Sales Office : Tel. 476 2241 - Fax : 476 2485

